

VOICE RECOGNITION TIPS

(If equipped)

HYUNDAI

BLUETOOTH®

Command

Example

Dial <Phone #> ——— “Dial 7-1-4-9-6-5-3-0-0-0”

Call <Name> ——— “Call John Smith”

Improving how you store your contacts can optimize your Bluetooth® Voice Recognition performance:

- Use full names instead of short or single-syllable names (“John or Dad”)
- Avoid using special characters/emojis or abbreviations (“Dr.”) when saving contacts

NAVIGATION

Command

Example

Find Address ——— “1-2-3-4-5 1st Street, <House #, Street, City, State>

Find <POI Name> — “Find McDonald’s®”

☐ BLUELINK

- Assist with creating MyHyundai.com account
- Assist with Bluelink enrollment
- Show Bluelink User's Manual
- Encourage customer to download the MyHyundai with Bluelink app

☐ INTRODUCTION AND LOCATION OF THE SERVICE DEPARTMENT

☐ SET FIRST SERVICE APPOINTMENT

☐ REVIEW FACTORY RECOMMENDED MAINTENANCE SCHEDULE

☐ WAS THE CONDITION OF YOUR VEHICLE (AT DELIVERY) TO YOUR SATISFACTION?

Sales Consultant	Date	Sales Manager	Date
Customer		Date	
Email			

MAINTENANCE				
Scheduled Maintenance	Normal Usage		Severe Usage*	
Engine Oil and Filter (3.8 GDI)	Replace	8,000 or 12 mos.	Replace	5,000 or 6 mos.
Fuel System Cleaner Additive	Add	7,500 or 12 mos.	Add	Same As Normal
Tire Rotation	Perform	8,000 or 12 mos.	Perform	Same As Normal
Air Cleaner Filter	Inspect	8,000 or 12 mos.	Replace	More Frequently
	Replace	24,000 or 36 mos.		
Battery Condition	Inspect	8,000 or 12 mos.	Inspect	Same As Normal
Vacuum Hose	Inspect	8,000 or 12 mos.	Inspect	Same As Normal
Climate Control Air Filter	Replace	16,000 or 24 mos.	Replace	More Frequently
Brake Hoses and Lines	Inspect	8,000 or 12 mos.	Inspect	Same As Normal
Drive Shafts and Boots	Inspect	16,000 or 24 mos.	Inspect	More Frequently
Exhaust Pipe and Muffler	Inspect	8,000 or 12 mos.	Inspect	Same As Normal
Front Brake Disc/Pads, Calipers	Inspect	8,000 or 12 mos.	Inspect	More Frequently
Rear Brake Disc/Pads	Inspect	8,000 or 12 mos.	Inspect	More Frequently
Steering Gear Box, Linkage & Boots, Lower/Upper Arm Ball Joint	Inspect	8,000 or 12 mos.	Inspect	More Frequently
Suspension Mounting Bolts	Inspect	8,000 or 12 mos.	Inspect	More Frequently
Propeller Shaft (AWD)	Inspect	16,000 or 24 mos.	Inspect	More Frequently
Brake Fluid	Inspect	8,000 or 12 mos.	Inspect	Same As Normal
	Replace	48,000 or 42 mos.		
Fuel Filter	Inspect	16,000 or 24 mos.	Inspect	Same As Normal
Fuel Lines, Fuel Hoses, and Connections	Inspect	16,000 or 24 mos.	Inspect	Same As Normal
Fuel Tank Air Filter	Inspect	16,000 or 24 mos.	Inspect	Same As Normal
Parking Brake	Inspect	16,000 or 24 mos.	Inspect	More Frequently
Vapor Hose and Fuel Filler Cap, Fuel Tank	Inspect	16,000 or 24 mos.	Inspect	Same As Normal
Transfer Case Oil (AWD)	Inspect	32,000 or 48 mos.	No Check	No Service Required
Rear Axle Oil (AWD)	Inspect	32,000 or 48 mos.	Replace	72,000
Valve Clearance	Inspect	64,000 or 72 mos.	Inspect	Same As Normal
Drive Belts	Inspect	1st: 48,000 or 72 mos.	Inspect	Same As Normal
		Add'l: 8,000 or 12 mos.		
Coolant	Replace	1st: 120,000 or 10 yrs.	Replace	Same As Normal
		Add'l: 30,000 or 24 mos.		
Spark Plugs (3.8 GDI)	Replace	96,000	Replace	More Frequently
Electroic Limited Slip Differential (e-LSD) oil	No Check, No Service required		No Check, No Service required	
Automatic Transaxle Fluid	-	-	Replace	60,000
*Check the engine oil regularly between recommended oil change. Hyundai recommends Quaker State oil.				
*See Owner's Manual for details.				

Looking for more detailed information? This Quick Reference Guide does not replace your vehicle's Owner's Manual. If you require additional information or are unsure of a specific issue, you should always refer to the vehicle's Owner's Manual or contact your authorized Hyundai dealer.

The information contained in this Quick Reference Guide was correct at the time of printing; however, specifications and equipment can change without notice. No warranty or guarantee is being extended in this Quick Reference Guide, and Hyundai reserves the right to change product specifications and equipment at any time without incurring obligations. Some vehicles are shown with optional equipment. Specifications apply to U.S. vehicles only. Please contact your Hyundai dealer for current vehicle specifications.

NP150S2023Q
(Rev 07/06/22)
Printing 07/09/22

The Hyundai PALISADE

Quick Reference Guide

Roadside Assistance: 1-800-243-7766
Customer Connect Center: 1-800-633-5151
Sirius XM® Radio: 1-800-967-2346
Bluelink: 1-855-2BLUELINK (1-855-225-8354)

HYUNDAI VEHICLE OWNER PRIVACY POLICY

Your Hyundai vehicle may be equipped with technologies and services that use information collected, generated, recorded or stored by the vehicle. Hyundai has created a Vehicle Owner Privacy Policy to explain how these technologies and services collect, use, and share this information.

You may read our Vehicle Owner Privacy Policy on the Hyundaiusa.com website at <https://www.hyundaiusa.com/owner-privacy-policy.aspx>. If you would like to receive a hard copy of our Vehicle Owner Privacy Policy, please contact our Customer Care Center at:

Hyundai Customer Care
P.O. Box 20850
Fountain Valley, CA 92728
800-633-5151
consumeraffairs@hmmausa.com

Hyundai's Customer Care Center representatives are available Monday through Friday, between the hours of 6:00 AM and 5:00 PM PST and Saturday between 6:30 AM and 3:00 PM PST (English). For Customer Connect Center assistance in Spanish or Korean, representatives are available Monday through Friday between 6:30 AM and 3:00 PM PST.

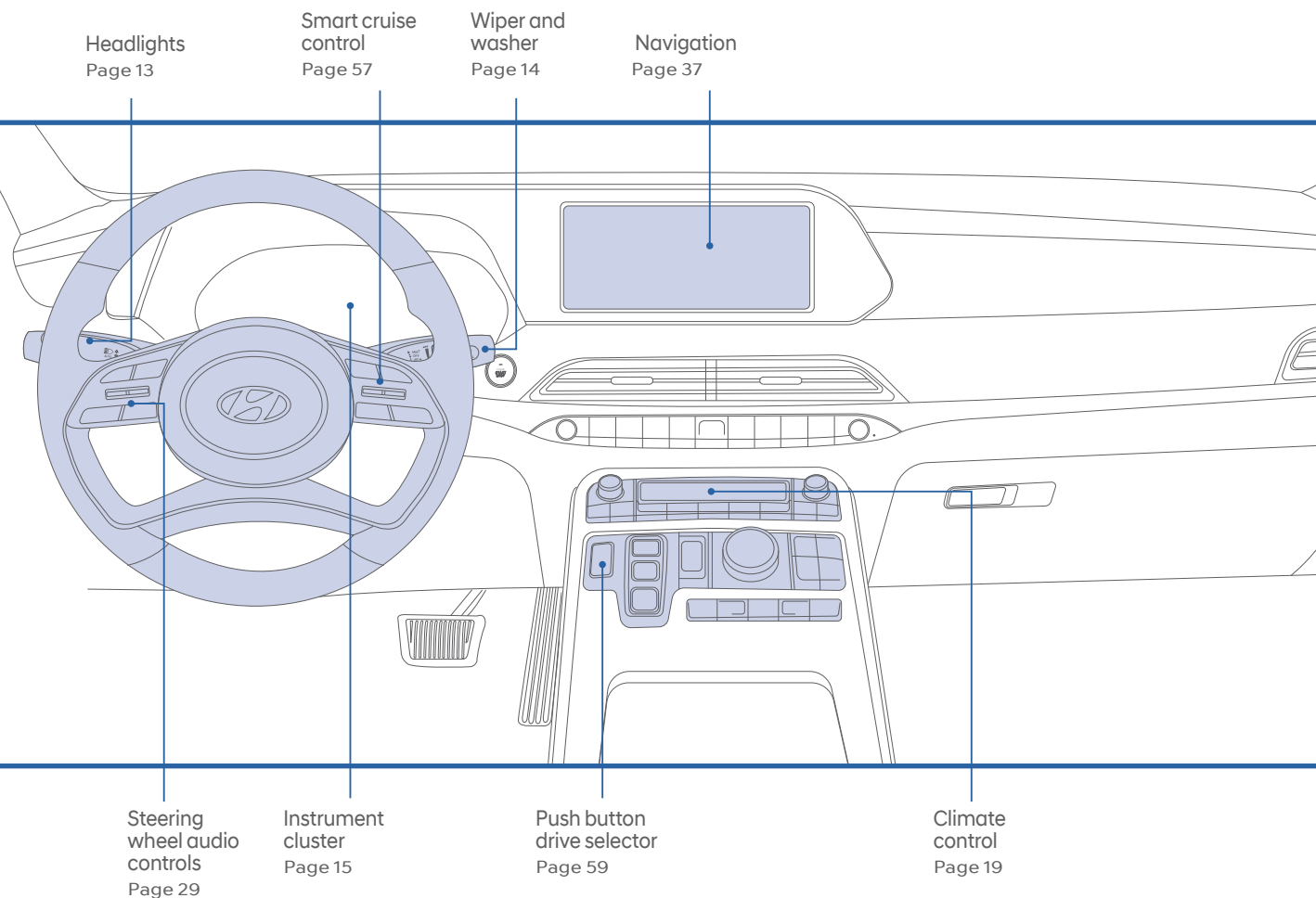

⚠ WARNING!

To reduce the risk of serious injury to yourself and others, read and understand the important SAFETY INFORMATION in your Owner's Manual.

Use this Quick Reference Guide to learn about the features that will enhance your enjoyment of your Hyundai. More detailed information about these features is available in your Owner's Manual.

FEATURES AND CONTROLS

Climate control	19
Digital key 2.0	04
Door locks	03
Fuel filler door	05
Hands free smart liftgate	11
Headlights	13
Head-up display (HUD)	12
Heated steering wheel	24
Homelink wireless garage control system	25
Instrument cluster	15
Instrument panel illumination	17
Interior lights	09
Power liftgate button	10
Rear climate control	23
Remote & Smart key	01
Seat-Front seat adjustment	05
Seat-Rear seat folding	07
Seat-Seat warmers and coolers	24
Seat-Third low heated seat	24
Sensor type door handle	02
Service Interval Reminder System	18
Sunroof	08
Trip computer	17
Warnings and indicators	16
Wiper and washer	14
Wiper blade removal/cleaning	14

INFOTAINMENT

Android Auto™	41
Apple CarPlay™	43
Bluelink telematic system	32
Bluetooth operational tips	29
Bluetooth phone operation	28
Bluetooth phone pairing	28
Digital center mirror	27
Home screen	35
Navigation	37
Radio mode	36
Steering wheel audio control	29
USB and smartphone port	39
USB- C Charging	40
Voice recognition tips	31
Wi-Fi Hotspot	40
Wireless cellular phone charging system	39





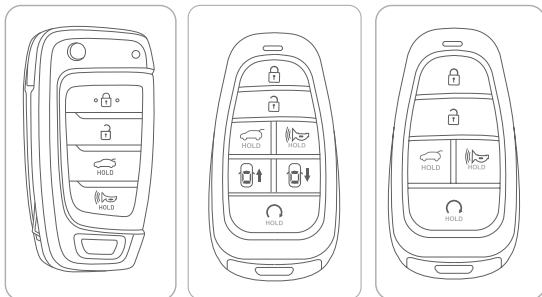

DRIVING

Auto hold	60
Blind Spot Collision-Warning (BCW)	50
Drive mode	54
Electric Parking Brake (EPB)	61
Forward Collision-Avoidance Assist (FCA)	49
Highway Driving Assist (HDA)	58
Idle Stop and Go (ISG)	53
Lane Following Assist (LFA)	48
Lane Keeping Assist (LKA)	47
Leading vehicle departure alert	58
Push button drive selector	59
Rear Cross-traffic Collision-Avoidance Assist (RCCA)	50
Rear Occupant Alert (ROA)	52
Safe Exit Assist (SEA)	51
Smart cruise control	57
Tire Pressure Monitoring System (TPMS)	56
Tow mode	62

*Some vehicles may not be equipped with all the listed features.

REMOTE & SMART KEY



-  **Lock**
-  **Unlock**
-  **Engine remote start button**
-  **Liftgate Unlock/Open** (Press and hold. Liftgate will open if equipped with Power Liftgate.)
-  **Panic**
-  **Remote Smart parking Assist** (Forward/Backward)

Note: To start the vehicle remotely, press and hold the remote start button for over 2 seconds within 4 seconds after locking the doors.”

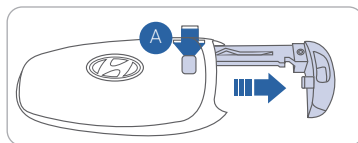

Removing the mechanical key

Hold the release button **A** to remove the mechanical key.

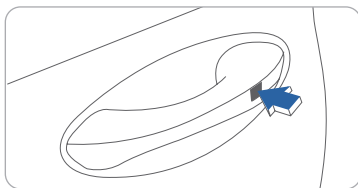

Driver's door Lock / Unlock

Smart key must be within 28~40in. from the outside door handle.

Press: One time - Unlock driver door
Two times - Unlock all doors
Three times - Lock all doors
if 2-press unlock is selected in the vehicle settings in instrument cluster/infotainment screen.

NOTE: User selectable option : Please see section 3 from Owner's Manual for more details.

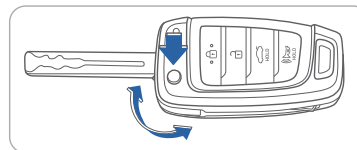

To unfold the mechanical key, press the release button on the remote.

SENSOR TYPE DOOR HANDLE

Sensor Type Door Handle Tips:

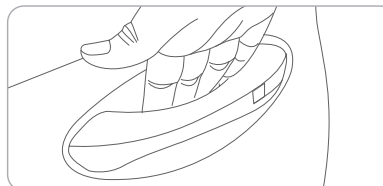

Unlock: Place your palm behind the door handle. It will unlock as you pull the door open.

Unlock with 2-Turn-Unlock enabled: Dip your palm twice behind the door handle before opening.

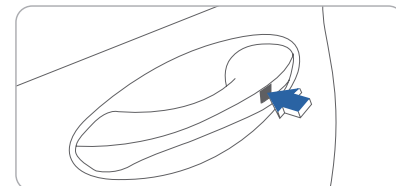

Lock: Touch the sensor near the leading edge to lock. All doors must be closed. Do not have your palm behind the handle.

DOOR LOCKS

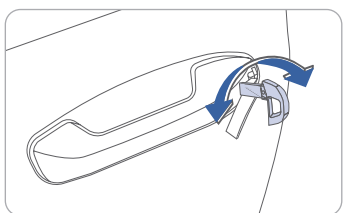
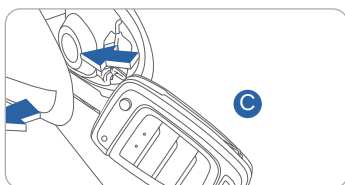
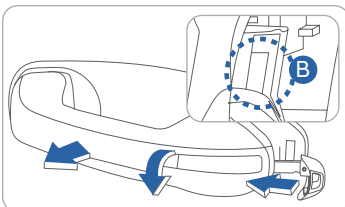
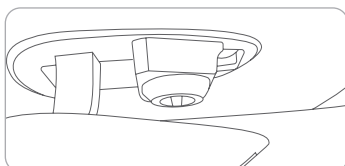
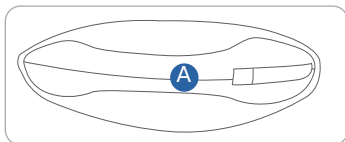

To access the key hole:

If the smart key is not working properly, there is an alternative way to unlock the doors through the keyhole on the driver's door.

1. Pull open the driver's door handle **A**
2. While holding the door handle open, use mechanical key to release the clip **B** behind the door handle.
3. Remove the key hole cover **C**

After removing the cover, turn the key clockwise to lock and counter clockwise to unlock. Once the door is unlocked it may be opened by pulling the handle.

DIGITAL KEY 2.0 (if equipped)

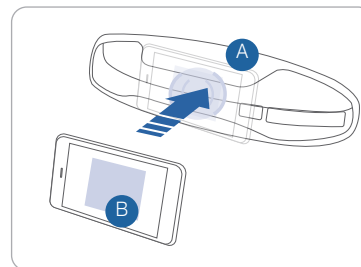

To use a digital key (smartphone), download the Blue Link App and sign up for a MyHyundai account.

Hyundai digital keys are only available on smartphones that support digital key functions.

Available smartphone models can be found on the Hyundai Motor website. For more information on digital key functions, please visit Hyundai Motor's website.

(<https://owners.hyundaiusa.com/us/en/resources/technology-and-navigation/introducing-all-new-digital-key.html>)



You can unlock your vehicle using the smartphone Digital Key, position your phone **B** near the door handle NFC touch sensor **A** of either the driver side or passenger side door. Hold your phone near the touch sensor area for about 2 seconds. You will hear the doors lock or unlock.

In the MyHyundai with bluelink app. Select your vehicle, then select digital key to activate the registration process.

FUEL FILLER DOOR

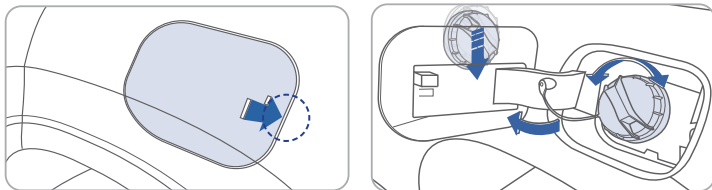

To open fuel filler door :

1. Press the rear center edge of the fuel filler door
2. Pull the fuel filler door out to fully open

NOTE : The fuel filler door will unlock when Driver's door is unlocked

To unlock fuel filler door:

- Press the unlock button on your smart key
- Press the Central Door unlock button on armrest trim of driver's door
- Pull the driver's inside door handle outward

The fuel filler door will lock when all doors are locked

To lock fuel filler door:

- Press the lock button on your smart key
- Press the Central Door lock button on armrest trim of driver's door

※ All doors will automatically lock after the vehicle speed exceeds 10 mph

Fuel door is also locked when vehicle speed exceeds 10 mph

FRONT SEAT ADJUSTMENT (MANUAL)



Forward/backward

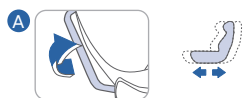

Seat cushion height (for driver's seat)

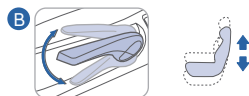

Seatback angle

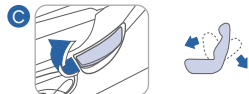

FRONT SEAT ADJUSTMENT (POWER)

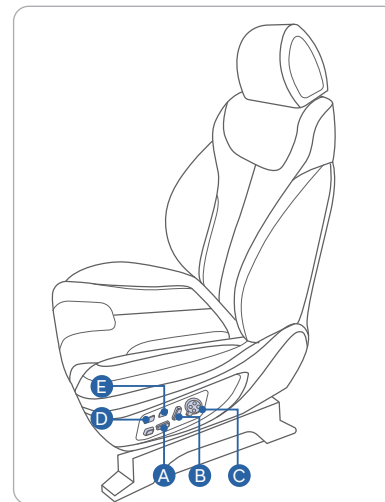

Forward / backward



Seat cushion height

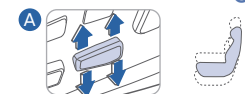

Seatback angle



Lumbar support (for driver's seat)



Seat Bolster Adjustment



Seat cushion extension



Comfortable Stretch Button

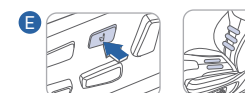

REAR SEAT FOLDING

2nd row seat

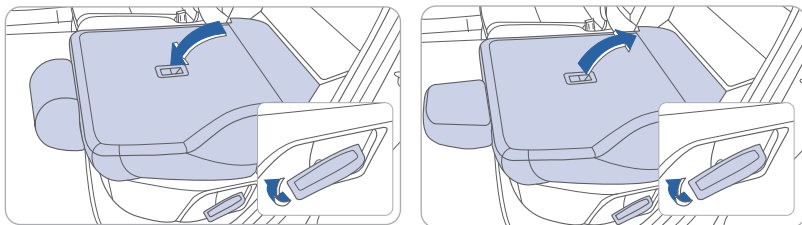

3rd row seat

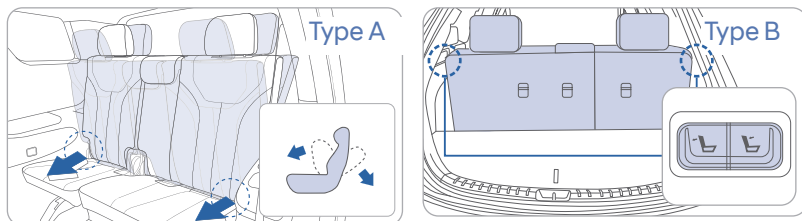

To adjust the third row seats, press the switch on the left and right side.

From cargo area

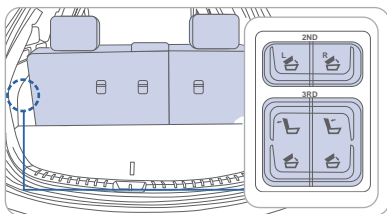

To fold the rear seats from the cargo area, push the 2nd or 3rd row seat back folding switch located on the left side of the cargo area.

Walk-in Seat

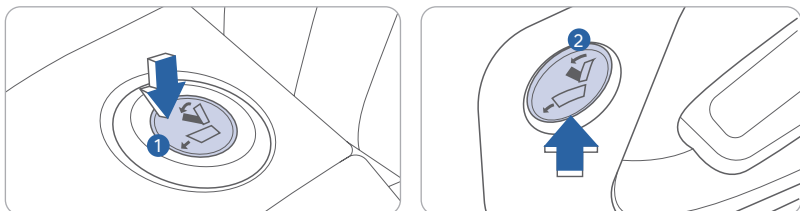

To get in or out of the third row seat, push the walk-in switch located on top of the 2nd row seat ① or on the side of the 2nd row seat ②.

SUNROOF

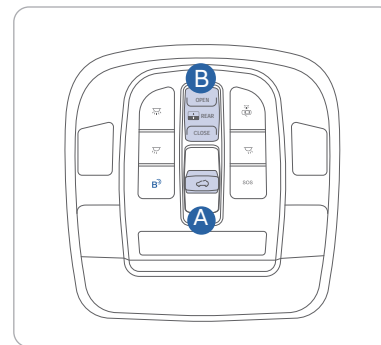

Sliding the Sunroof



Pressing the sunroof control switch ① backward or forward momentarily to the second detent position completely opens or closes the sunroof even when the switch is released. To stop the sunroof at the desired position while the sunroof is in operation, press the sunroof control switch ① backward or forward and release the switch.

Rear Power Sunshade



To open the rear sunshade, press the open ② button. To Close the sunshade, press the close ③ button

Front Sunshade

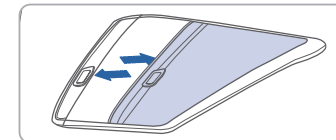

The sunshade will open automatically with the sunroof when the glass panel moves. If you want it closed, move the sunshade manually when the glass panel is closed.

Tilting the Sunroof

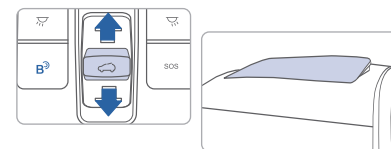

Open

Push and hold the sunroof control switch upward to tilt open the sunroof.

Close

Push and hold the sunroof control switch forward to tilt close the sunroof.

NOTE: If your vehicle is equipped with a dual wide sunroof, you can slide your rear blind with the rear blind control button ②.

INTERIOR LIGHTS

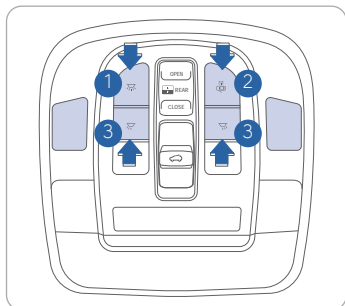

Room Lamp (Rear)

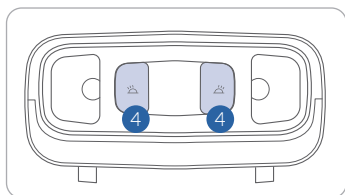

Master Switch (1)

Push the switch to turn the map lamp (3) and room lamp (4) on or off.

When the Master Switch (1) is pushed, the other switches (3, 4) do not operate.

Door Mode Switch (2)

When the Door Mode Switch (2) is pushed, map lamp (3) and room lamp (4) turn on if any door is opened and will turn off after all doors are closed.

Map Lamp (Lens Switch) (3)

Press the switch to turn on and off for each side of map lamp.

Room Lamp Switch (4)

Press the switch to turn on and off the room lamp.

When this switch is pushed, master switch can't control room ramp

Cargo Lamp (Cargo headliner)

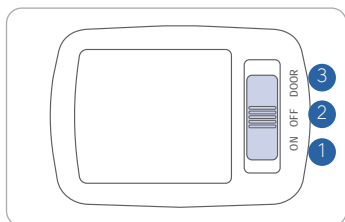

- 1 ON
- 2 OFF
- 3 Door Mode

1. When the SWITCH (1) is set to ON,
- the CARGO lamp turns on
2. When the SWITCH (1) is set to OFF,
- the CARGO lamp turns OFF
3. When the SWITCH (1) is set to DOOR,
- the CARGO lamp turns ON when tail gate is opened

POWER LIFTGATE BUTTON

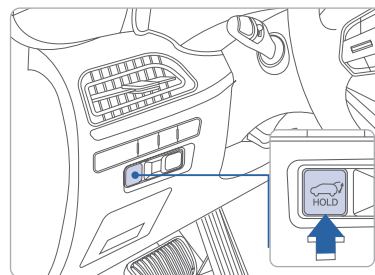

When the ignition is on and the vehicle is in park, the power liftgate can be opened by using the console button on the dash. Before using the power liftgate, make sure it is selected in the User Setting modes in the LCD display.

To Activate:

Setup → Vehicle → Door → Power Liftgate

Adjusting Speed:

The speed of the power liftgate can be adjusted in the User Settings mode in the LCD display.

Setup → Vehicle → Door → Power Liftgate Speed → Normal/Fast

HANDS FREE SMART LIFTGATE

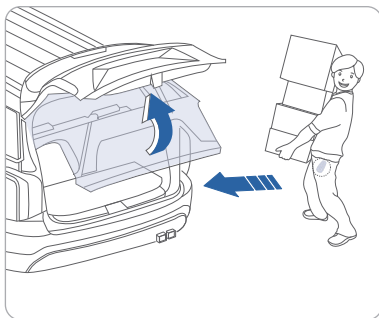

On vehicles equipped with Smart Liftgate, the liftgate can be opened with no-touch activation.

To activate

To enable Smart Liftgate, go to User Settings mode on the LCD display, or Setup, then Vehicle on the Navigation display and under the Door menu make sure the Power Liftgate and Smart Liftgate boxes are checked.

Power Liftgate Opening Height

For your convenience, there are four levels to adjust the liftgate opening height. These can be selected in the User Settings menu.

1. Select User Settings from the LCD Display, or Setup - Vehicle from the Navigation screen.
2. Select Door Menu, then Power Liftgate Opening Height
3. Choose between Level 1 ~ 3 or Full Open

Hands Free Smart Liftgate Operation

The liftgate can be opened with no-touch activation after the below conditions are met:

- After 15 seconds from when all doors are closed and locked
- You approach the rear of the vehicle (liftgate area) for at least 3 seconds with the Smart Key in your possession

HEAD-UP DISPLAY (HUD)



The Head-Up Display is an optional feature that allows the driver to view information projected onto a transparent screen while driving.

To Activate:

On the All Menus screen, press Setup > Vehicle - Head-up display > Enable Head-up display

NOTE: If you wear polarizing-filter sunglasses, it may be difficult to read the Head Up Display information.

HEADLIGHTS

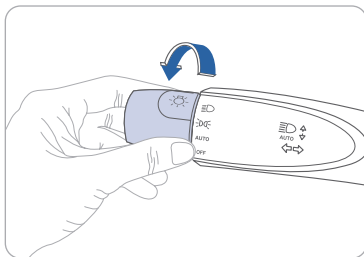

- ▶ | Headlights
- ▶ | Parking lights
- ▶ | **AUTO** Auto lights
- ▶ | **OFF** All lights off

Headlight delay

Headlights may stay on for 15 seconds after exiting and locking vehicle. Press remote lock button twice to turn headlights off.

See Owner's Manual for more detail.

Turn signals and lane change signals Flashing headlights

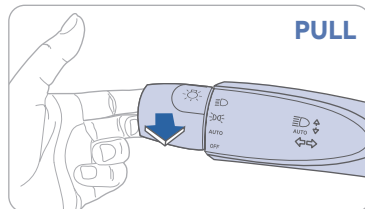
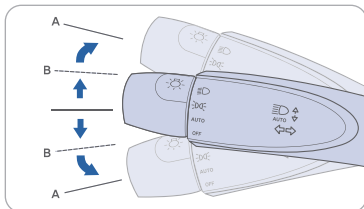

High beam / Smart high beam

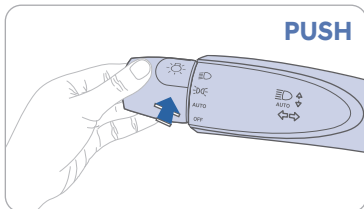

Smart High Beam Function

1. Select auto position in headlights functions
2. Push lever forward to engage Auto High beam.
3. Push lever forward again to disengage.

Anti-Glare Cutout (if LED projection headlight equipped)

The Anti-Glare Cutout is a safety feature that enables the automaker to increase visibility on the driver's side of the vehicle while reducing the glare to oncoming traffic.

Do not replace the headlamp assembly for concerns related to the Anti-Glare Cutout.

WIPER AND WASHER

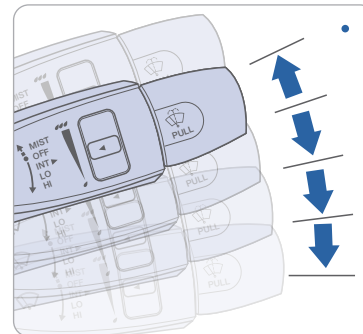

- MIST - Single wipe
- OFF - Off
- AUTO - Auto control wipe
- LO - Normal wiper speed
- HI - Fast wiper speed

NOTE: The rear wiper is controlled by the knob at the end of the wiper stalk. Turn the knob forward one stop for low wipe speed and two stops for high wipe speed

WIPER BLADE REMOVAL/CLEANING

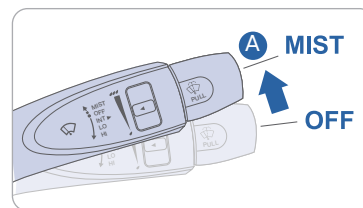

This vehicle has a "hidden" wiper design which means they cannot be lifted in their bottom resting position.

Wiper Blade Removal

1. Within 20 seconds of turning off the engine, lift and hold the wiper lever up to the MIST **A** position for about 2 seconds until the wipers move to the top wipe position.
2. At this position, you are able to lift the wipers off the windshield.
3. Gently put wipers back down onto windshield.
4. Turn the wipers to any ON position to return to resting position.

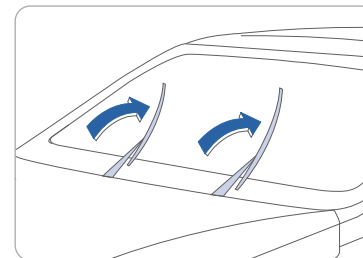

NOTE: To prevent damage to the hood and wiper arms, the wiper arms should only be lifted when in the top wiping position.

INSTRUMENT CLUSTER

Type A



Type B



- ① Tachometer
- ② Speedometer
- ③ Engine coolant temperature gauge
- ④ Fuel gauge
- ⑤ Warning and indicator lights
- ⑥ LCD display

WARNINGS AND INDICATORS

Airbag warning light	Seat belt warning light	Parking brake & Brake fluid warning light
ABS warning light	Electronic Brake force Distribution (EBD) System warning light	
Electric Power Steering (EPS) warning light	Malfunction Indicator Lamp (MIL)	Charging system warning light
Engine coolant temperature warning light	Engine oil pressure warning light	Low fuel level warning light
Low Tire Pressure Warning Light/TPMS system malfunction light	Electronic Stability Control (ESC) indicator	Electronic Stability Control (ESC) OFF indicator
AWD warning light	Immobilizer indicator	Turn signal indicator
Highway Driving Assist indicator	Light ON indicator	Idle Stop and Go (ISG)
High beam indicator	CRUISE Cruise ON indicator	SET Cruise SET indicator
AWD LOCK indicator	Smart high beam indicator	EPB Electric Parking Brake (EPB) warning light
Downhill Brake Control (DBC) indicator	Forward safety warning light	AUTO HOLD indicator light (if equipped)
SPORT Mode indicator light	Low beam indicator	Icy road warning light (If equipped)
Steering safety warning light	Master warning light	Lane safety indicator

TRIP COMPUTER

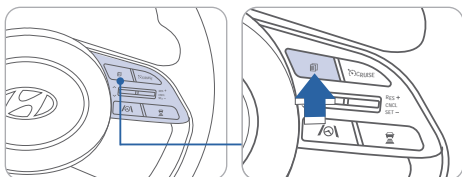

Select "Trip Computer" mode by pressing the MODE button .

To change the trip mode as follows, toggle this switch .

Trip modes

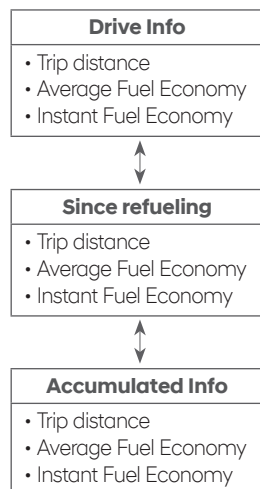

INSTRUMENT PANEL ILLUMINATION

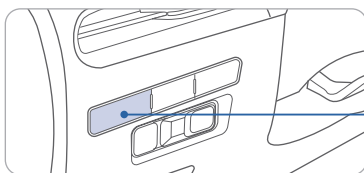

Press the control button left (-) or right (+) to adjust the brightness.



SERVICE INTERVAL REMINDER SYSTEM

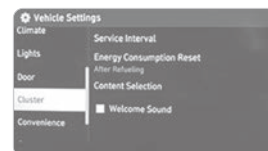

This system is designed to notify you of your next vehicle maintenance interval

To Activate:

Press the SETUP button on the control panel and select VEHICLE SETTINGS on the screen.

Select the following:

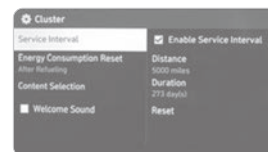

Cluster > Service Interval > Enable Service Interval > Enter Interval Distance/Time

MANUAL CLIMATE CONTROL

Manual Type

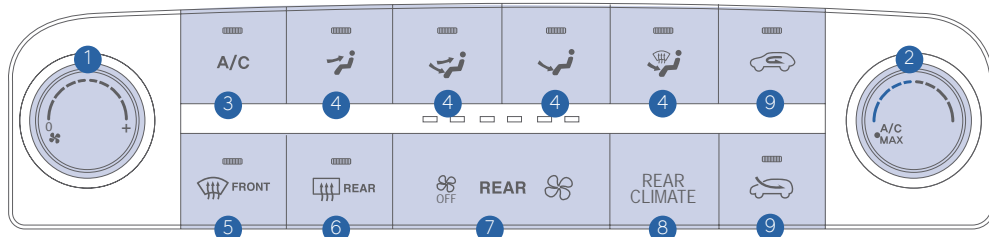

1. Fan speed control knob
2. Temperature control knob
3. Air conditioning button
4. Mode selection button
5. Front windshield defroster button
6. Rear window defroster button
7. Rear fan speed control button
8. Rear climate control button
9. Air intake control button

DEFROSTING / DEFOGGING



1. Press the front windshield defroster button.



2. Set the temperature control to the warmest setting.



3. Set the fan speed to the higher setting.

NOTE:

To reduce the tendency of the glass to fog up and also to improve visibility, keep the surface of the windshield clean by wiping it occasionally with glass cleaner and a clean cloth.

In addition, select air intake control to the outside (fresh) air position whenever possible while operating the vehicle.

AIR INTAKE CONTROL

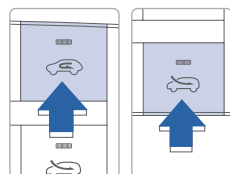

Recirculated air position

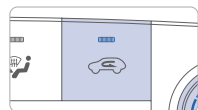

Outside (fresh) air position

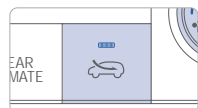

MODE SELECTION

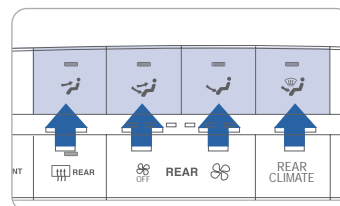

Changes the direction of the air flow as following:

- Face Level
- Bi-Level
- Floor Level
- Floor / Defrost Level

REAR WINDOW DEFROSTER

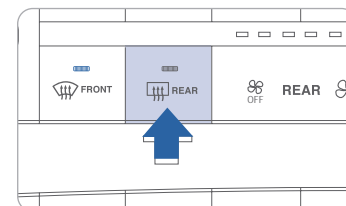

Press to activate / deactivate the rear defroster.

MAX A/C MODE

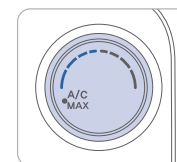

The MAX A/C automatically selects the A/C, recirculated air, and face level vents. This helps to cool the cabin down more quickly. Select normal A/C after initial cool down to resume fresh airflow and maintain efficiency.

AUTOMATIC CLIMATE CONTROL

- 1 Driver's temperature control knob
- 2 Passenger's temperature control knob
- 3 AUTO (automatic control) button
- 4 SYNC button
- 5 Front windshield defroster button
- 6 Air conditioning button
- 7 OFF button

IBN Type

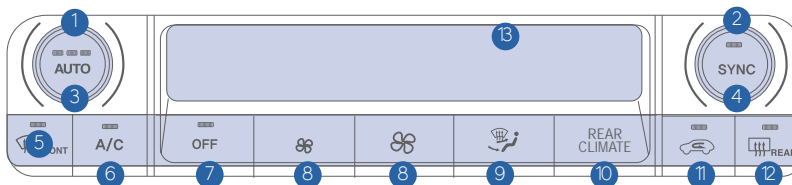

- 8 Fan speed control button
- 9 Mode selection button
- 10 Rear climate control button
- 11 Air intake control button
- 12 Rear window defroster button
- 13 Climate control information screen

DEFOGGING/DEFROSTING



1. Press the front windshield defroster button.



2. Set the temperature control to the warmest setting.

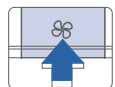

3. Set the fan speed to the higher setting.

SYSTEM OFF

Pressing the OFF button will place the system to the OFF mode.

- Climate control fan will turn off.
- Outside (fresh) air position will be selected.
- Vented air will be at last set temperature.

REAR CLIMATE CONTROL BUTTON

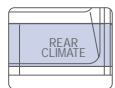

Used to move to the climate control screen for the rear seat. You can check or set the climate status for the rear seat.

NOTE:

To reduce the tendency of the glass fogging and also to improve visibility, keep the interior surface of the windshield clean by wiping it with a clean cloth and glass cleaner. In addition, select air intake control to the outside (fresh) air position whenever possible while operating the vehicle.

AUTOMATIC HEATING / AIR CONDITIONING



The modes, fan speeds, air intake and air conditioning will be controlled automatically by the temperature setting you select.

It is recommended to use the AUTO function with 72°F temperature set point for optimum comfort and efficiency. Adjust the temperature as desired.

AIR INTAKE CONTROL



Recirculated air position (LED on)



Outside (fresh) air position (LED off)

MODE SELECTION



Changes the direction of the air flow as following:



REAR CLIMATE CONTROL (AUTOMATIC)

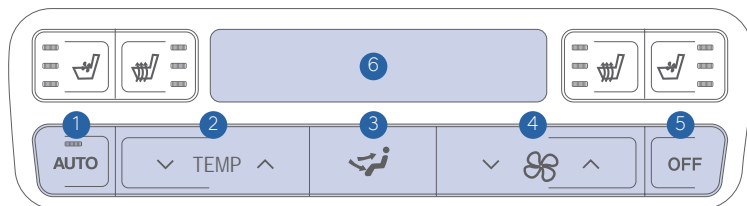

- ① AUTO button
- ② Temperature control button
- ③ Mode selection button
- ④ Fan speed control button
- ⑤ OFF button
- ⑥ Climate control information screen

REAR CLIMATE CONTROL (MANUAL)

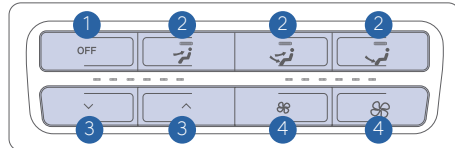

- ① OFF button
- ② Mode selection button
- ③ Temperature control button
- ④ Fan speed control button

NOTE:

If you press the rear climate control button of the front climate control system, rear passengers can control the rear climate system by using the rear climate control system.

HEATED STEERING WHEEL

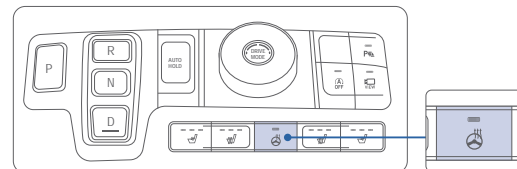

Pressing the heated steering wheel button warms the steering wheel. The indicator light on the button is illuminated when this feature is turned on.

SEAT WARMERS AND COOLERS (FRONT SEATS)

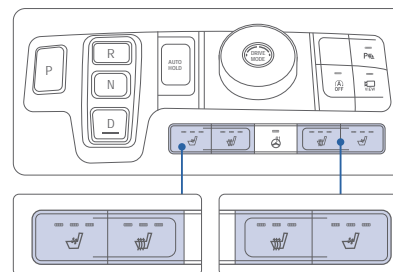

- Heat
- Air Ventilation

Each time you push the button, the setting is changed as follows:



SEAT WARMERS AND COOLERS (REAR SEATS)



NOTE:

To turn off immediately, press and hold the button.

THIRD ROW HEATED SEAT (if equipped)

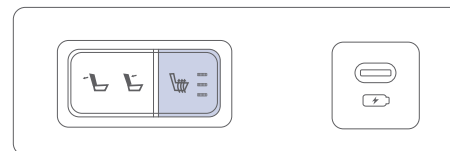

Located on the side above cupholder.

HOMELINK WIRELESS GARAGE CONTROL SYSTEM —

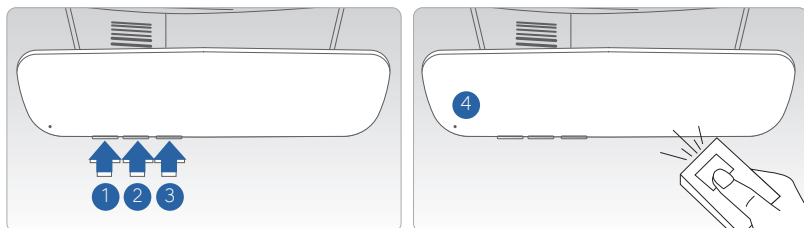

Standard Programming

1. Press and release (1), (2) or (3) button.
 - If the indicator (4) flashes slowly in Red, go to Step 3 (Programming)
 - If the indicator (4) is continuously turned ON or flashes rapidly in Red several times, go to Step 2 (Erasing)
2. Press and hold the button you wish to program for approximately 15- 25 seconds until the LED flashes slowly in Red.
3. Hold the Garage Door Opener Original Transmitter near the HomeLink Mirror.
4. Press and hold the desired button ((1), (2), or (3)) and the Original Transmitter button until the indicator (4) is turned continuously ON or flashes rapidly in Red and it indicates the programming is completed.

NOTE: If the indicator (4) flashes rapidly in Red continuously, but if the garage door opener does not operate, please continue to follow Rolling Code Programming steps below.

Rolling Code Programming

- ※ You may need a ladder to access your garage door opener.
- ※ You may need help from a second person.
- ※ Be prepared some of the steps are time sensitive.

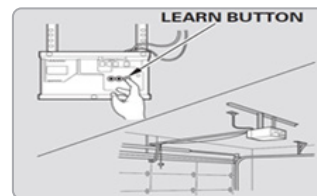

1. Firmly press and release the “Learn,” “Smart,” or “Program” button of garage door opener while the indicator (4) flashes slowly in Red. Once the button is pressed, you have approximately 30 seconds to initiate the next step.
2. Return to the vehicle and firmly press the HomeLink button, hold for two seconds and release the button up to three times. Do not press the HomeLink button rapidly. At this point programming is complete and your device should operate.

For more detailed information, please refer to your Owner’s manual or visit www.homelink.com or call (800) 355-3515

DIGITAL CENTER MIRROR (if equipped)

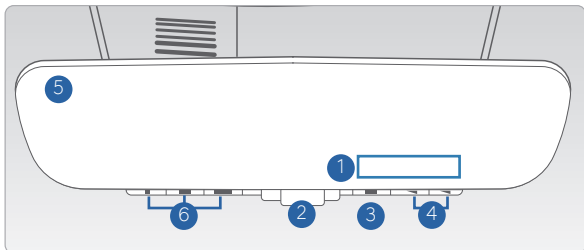

The Digital Center Mirror is a system that uses the camera on the rear of the vehicle and displays its image on the screen of the Digital Center Mirror. The Digital Center Mirror allows the driver to see the rear view despite obstructions, such as the headrest or luggage, ensuring rear visibility.

- 1 Icon display area Displays icons, adjusting Brightness & Tilt
- 2 Lever Operate to change between digital mirror mode and optical mirror mode.
- 3 Menu button Press to display the icon display area and select the item you want to adjust (Brightness & Tilt).
- 4 Select/adjust button Press to change the setting of the item you want to adjust.
- 5 Camera indicator Indicates that the camera is operating normally.
- 6 HomeLink buttons For the operation of the "HomeLink® Universal Transceiver.

BLUETOOTH PHONE PAIRING

Pairing tutorials, phone compatibility and operational tips can be found through the Smart QR code using the QR reader application on your Smartphone.



BLUETOOTH PHONE OPERATION

Phone setup (pairing phone)

1. Turn Bluetooth® on from your mobile phone. :
One the all Menus screen, press Setup → Device Connections → Device Connections → Add New.

To register a device for the first time, press the Call button on the steering wheel or by pressing Phone oh the All Menus screen.



2. Turn on Bluetooth on the Bluetooth device to connect and select the vehicle system on the list of searched devices.
✍ The system's Bluetooth name can be seen on the Add New Device window.



3. Check that the authentication code on the Bluetooth device screen matches the one on the system and approve the connection on the device.
4. When your smartphone is using Bluetooth communication, to download contacts from the phone to the system or use the text message notification, allow access to your phone.

STEERING WHEEL AUDIO CONTROL

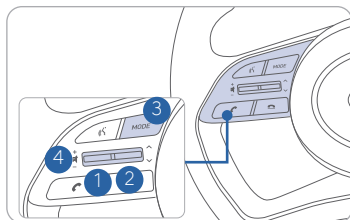

- 1 **VOLUME**
Raises or lowers the speaker volume.
Press to Mute.
- 2 **SEEK / PRESET**
Changes the station.
- 3 **MODE**
Changes the audio source.

- 3 **MODE**
Press the MUTE button to mute the sound
Press the MUTE button again to activate the sound

BLUETOOTH OPERATIONAL TIPS

In the following situations you or the other party may have difficulty hearing each other:

1. Keep the Bluetooth volume low. High level volume may result in distortion and echo.
2. When driving on a rough road, high speeds and/or with the window open.
3. When the air conditioning vents are facing the microphone and/or when the air conditioning fan is at the max speed.

Steering wheel bluetooth control

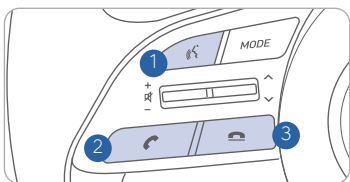

- 1 **VOICE RECOGNITION**
Activates the voice recognition of a connected smartphone via phone projection. Activated system voice recognition on vehicles equipped with navigation.

- 2 **CALL/ END CALL BUTTON**
 - Before connection of Bluetooth: Press to display the Bluetooth connection window.
 - After connection of Bluetooth, Press to display the recent calls list. To redial the last call number, press and hold the button.
 - During a Bluetooth call: Press to end a call.
 - When a call comes in: Press to answer the call. To reject the call, press and hold the button.

- 3 **CUSTOM BUTTON**
 - Runs the user-defined function.
 - Press and hold the button to display the function settings screen.

Making a call using voice recognition:

Use your smartphone's functions, such as calling and messaging, from the [push to talk] button.

One vehicles equipped with navigation, use the [push to talk] button to activate the system voice recognition.

the menu tree identifies available voice recognition Bluetooth® functions.

Calling by Name:

1. Press the button.
2. Say the following command:
 - "Call <John>": Connects the call to John.
 - "Call <John> <on Mobile / at Work / at Home >": Connects the call to John's Mobile, Home, or at Work phone number.

Dialing by Number:

1. Press the button.
2. Say "Dial Number".
3. Say the desired phone number.

For the complete list of commands, please refer to your Owner's Manual.

VOICE RECOGNITION TIPS

Your vehicle is equipped with a Voice Recognition technology, which allows drivers to operate their phones without having to take their eyes off the road to minimize distractions.

Voice recognition performance may be affected if driving with windows and sunroof open; when the heating-cooling system is on; when passing in a tunnel or when driving on rugged and uneven roads.

Quick reference on using voice commands:

To start a voice command, press the  button, the following commands are available:

Command	Function
More Help	Provides guidance on commands that can be used anywhere in the system.
Help	Provides guidance on commands that can be used within the current mode.
Calls <Name>	Calls <Name> saved in Contacts. Ex) Call "John"
Dial <Number>	Call can be made by dialing the spoken numbers. Ex) Call "123"
Phone	Provides guidance on Phone related commands. After saying this command, say "Call History", "Contacts" to execute the corresponding functions.
Contacts (Call by Name)	Displays the Contacts screen. After saying this command, say the name of a contact saved in the Contacts to automatically connect a call.
Dial Number	Displays the Dial number screen. After saying this command, you can say the number which you want to call.

BLUELINK TELEMATICS SYSTEM

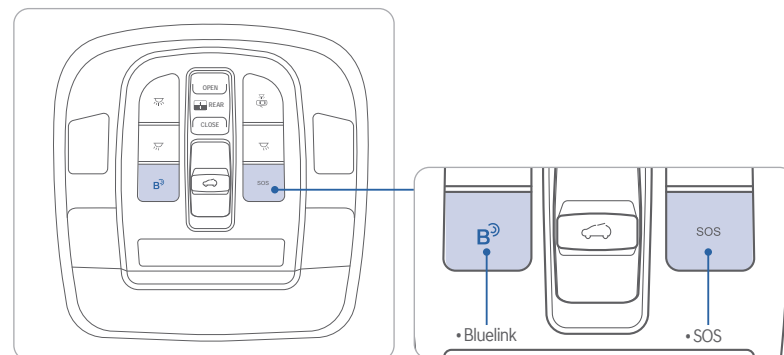

Press the  button for access to the voice-response menu of services.

You can say:

- "Service Link" to schedule a service appointment.
- "Roadside Assistance" for roadside services.
- "Bluelink Account Assistance" for help with your Bluelink subscription.
- Press the **SOS** button for SOS Emergency Assistance.
- Refer to your Bluelink User's Manual for detailed information on system operation.
- For immediate assistance with subscription services, please call 1-855-2BLUELINK (1-855-225-8354).

Google® is a registered trademark of Google Inc.

Remote Start

Remote Start



You can download the BlueLink mobile app to your compatible smart phone from the following sites:

- iPhone® — Apple® App Store
- Android® — Google Play

Remote Start enables you to remotely start your vehicle from virtually anywhere. For navigation vehicles, you can also enable climate control remotely and turn on the rear-window defroster, ensuring a warm or cool car is ready to go when you are.

- To use this feature, you must have a BlueLink Personal Identification Number (PIN). To create or change your PIN, log on to www.MyHyundai.com.

Remember:

- Remote Start with Climate Control will automatically shut off after 10 minutes or after selected engine timer runs out in navigation vehicles.
- While this feature is active, the parking lights will blink until vehicle is turned off or when vehicle is in operation.
- To continue operation of the vehicle, the proximity key must be inside the vehicle with the driver prior to pressing the brake and being able to move the gearshift from the P (Park) position.

Preconditions:

- Ignition is OFF
- Alarm is armed (i.e., vehicle locked by key fob Remote Door Lock)
- Vehicle gear status is in P (Park)
- Brake pedal is not depressed
- Engine hood is securely closed
- All the doors are closed and locked
- The tailgate or trunk lid is closed
- The security/panic system is not activated
- The proximity key is not inside the vehicle
- The battery power is not low
- Vehicle is located in an open area
- It has been less than 4 days since last vehicle ignition off
- Vehicle located in area with good cell reception

Remote Start will terminate:

- After 10 minutes or after selected engine timer runs out in navigation vehicles
- Brake is pressed without proximity key inside vehicle
- Alarm is triggered without proximity key inside vehicle
- Door/trunk is opened from inside the vehicle

Notice: Laws in some communities may restrict the use of the features that remotely start the engine. For example, some laws may require a person using the remote start feature to have the vehicle in view when doing so or limit the length of time a vehicle engine may idle. Please check local and state regulations for any requirements and restrictions on remote starting of vehicles and engine idling time.

⚠ WARNING!

Do not remote start vehicle in an enclosed environment (i.e., closed garage). Prolonged operation of a motor vehicle in an enclosed environment can cause a harmful build-up of carbon monoxide. Carbon monoxide is harmful to your health. Exposure to high levels of carbon monoxide can cause headaches, dizziness or in extreme cases unconsciousness and/or death. Do not leave children or animals unattended in a vehicle while using the remote start function.

⚠ CAUTION!

If the vehicle's windshield wipers are left on when the vehicle was last driven, then the wipers will turn on if the remote start function is activated. To avoid damage to the wiper blades (i.e., due to heavy ice or snow accumulated on the windshield), please always turn the vehicle's windshield wipers off when parking the vehicle.

HOME SCREEN

Home screen (Type2)

The Home screen layout is as follows

✎ To return to the Home screen from other screens, press .



1 Displays the specified user profile image. To display the user profile settings screen, press the user image or name.

2 Displays time, weather, and other information.

✎ The screen may differ depending on the vehicle model and specifications.

✎ To display the map screen, press the map area.

Seeing the all menus screen

You can see all menus on the Home screen.

Press and gently swipe the Home screen to the left as shown below.

The all menus screen appears. You can see the list of all functions of the system.

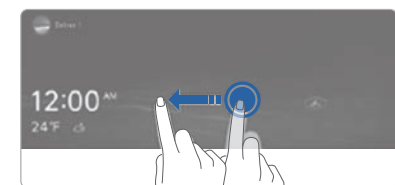

✎ The screen may differ depending on the vehicle model and specifications.

RADIO MODE

Radio screen (Type2)

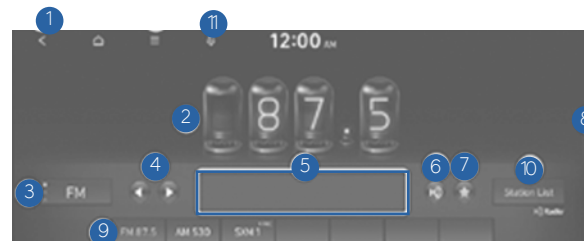

The radio screen provides various functions while listening to radio broadcasts.



1 Returns to the previous step.

2 Radio broadcast information.

3 Can change the radio mode.

4 Can change the frequency. Shortly press to switch to the previous/next frequency, or press and hold to quickly change the frequency. When you release the  or  button, the previous or next channel with good reception is automatically selected.

5 Shows information about the radio channel you are currently tuned in to.

6 Activate the HD Radio mode.

7 You can delete or save the current frequency to the presets list.

8 Can turn on or off the split screen mode.

9 Presets list.

10 Can see the list of available radio stations (if equipped).

11 You can change radio channels by using voice commands.

NAVIGATION

Basic features on the map screen

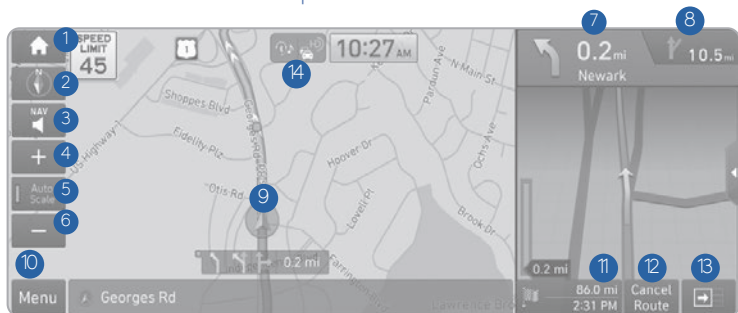

- 1 Displays the Home screen.
- 2 Used to change the map display mode.
- 3 You can adjust the volume of navigation or GPS warning sound.
- 4 Zoom in the map
- 5 The scale of the map automatically changes.
- 6 Zoom out the map
- 7 Guides the point to change the driving direction.
- 8 Guides the next point to change the driving direction.
- 9 Displays the lanes in different colors.
- 10 Displays quick menu items that can be used during a guidance.
- 11 Displays the remaining distance to the destination and the estimated time of arrival. For more details, touch the information item.
- 12 Can cancel the route guidance.
- 13 Displays or hides the detailed guidance.
- 14 You can see the system information on the map.

Destination search screen



- 1 Returns to the previous step.
- 2 Customize the navigation settings.
- 3 Search for a location by entering various types of keywords such as place name and address.
- 4 Search for a location by using the point of interest (POI) categories.
- 5 Select one of the destinations you entered previously.
- 6 Select one of the locations stored in your saved places.
- 7 Search for Hyundai Dealerships easily.
- 8 Cancel guidance to the destination.
- 9 View information on the entire route to the destination.
- 10 Edit the waypoints on the way to the destination.
- 11 Reroute by changing the route search option.
- 12 You can check accident and construction zone alerts on the map.

WIRELESS CELLULAR PHONE CHARGING SYSTEM

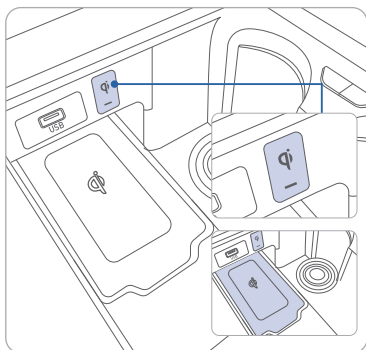

There is a wireless cellular phone charging system inside the front console. The system will operate when all doors are closed, and the ignition switch is in the ON position.

NOTE:

The wireless cellular phone charging system supports only the Qi-enabled cellular phones (Qi).

NOTE:

Do not place any metallic items such as coins, keys on the charger. Avoid putting credit cards, etc. on the charger as they might get damaged by the magnetic field.

NOTE:

User selectable option. Please see section 3 from Owner's Manual for more details.

USB AND SMARTPHONE PORT

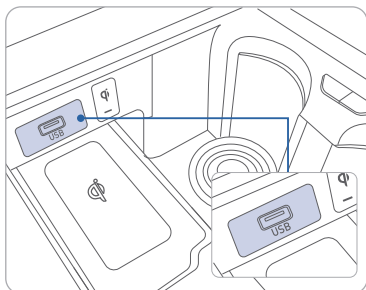

Use the USB ports to connect an external audio device and listen to it through the audio system in your vehicle.

Use this USB port to access Android Auto or Apple CarPlay with your compatible phone.

USB-C CHARGING

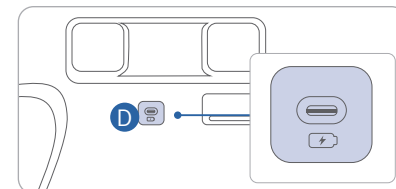
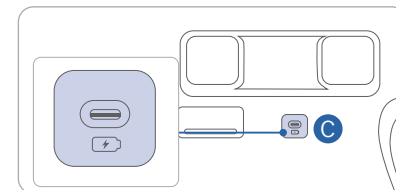
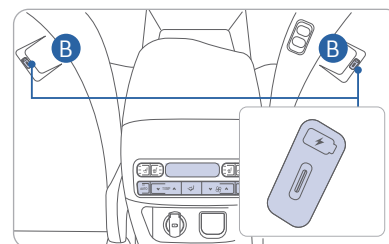
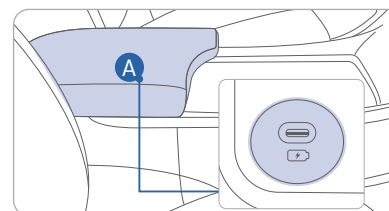
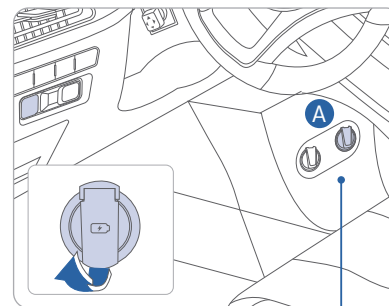

The USB-C charger is designed to recharge batteries of electrical devices using a USB-C cable. They are located in 5 spots around the vehicle, with two in the front row, one in the 2nd row, and 2 in the 3rd row.

- A (Front row)
- B (2nd Row)
- C and D (3rd Row)

Wi-Fi HOTSPOT

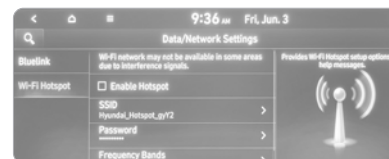

You can enable the Wi-Fi Hotspot function on system in the vehicle. Registering a device using the Wi-Fi Hotspot is required to access a network and connect or disconnect a registered device.

Depending on the network signal status, access to Wi-Fi Hotspot may be restricted.

ANDROID AUTO™

REQUIREMENTS:

- USB cable
- OS Android™ 5.0 or higher
- Compatible Android Phone
- Data and wireless plan for applicable features

BEFORE YOU BEGIN:

- Android Auto features may operate differently than on your phone.
- Message and data charges may apply when using Android Auto.
- Android Auto relies on the performance of your phone. If you experience performance issues:
 - Close all apps and then restart them
 - Disconnect and then reconnect your phone
- Using the USB cable that was provided with your phone is recommended.
- When Android Auto is active, your in-vehicle voice recognition system is disabled and you will be using talk to Google™ to make your requests.

ANDROID AUTO SUPPORT



<https://support.google.com/androidauto/>

REMINDERS:

- Android Auto™ compatibility requirements for connection:
 - UVO link with Navigation (USB cable connection only): OS Android™ 5.0 or higher, phone manufacturer's USB cable and data plan for applicable feature(s)
 - Standard Audio System-Value (USB cable & wireless connection):
 - USB cable connection – OS Android™ 5.0 or higher, phone manufacturer's USB cable and data plan with applicable feature (s)
 - Wireless connection – OS Android™ 9.0 or higher with data plan for applicable feature(s)
- It is recommended to always update your phone to the latest operating system release
- Wireless Android Auto™ system only works for certain Android models. Use the manufacturer's USB cable when wireless feature is not available

PHONE SETUP

Turn on Bluetooth® on your phone and connect the micro USB cable to your phone and the USB port on the vehicle.

Phone will prompt you to download the Android Auto app and update other needed apps (e.g. Google Maps™, Google Play Music™, Google Now™).

NOTE: Vehicle must be parked.

- Location mode setting should be set to High accuracy.
- Car and phone setup should be completed in one sitting. If phone setup needs to be resumed, recommend to Force Stop the Android Auto app on the Phone then reopen the app and accept the Disclaimer notifications.

CAR SETUP

1. Press the SETUP button on the radio.
2. Touch the “Device Connections” icon on screen.
3. Select “On” for Android Auto.
4. Connect your Android phone to the vehicle USB port. Agree to the notification and disclaimers on your phone then the “Android Auto” icon will appear confirming the setup.

For more detailed information on how to operate Android Auto, please refer to your display audio or navigation manual.

For additional Android Auto support, please refer to the Android Auto Support Website
<https://support.google.com/androidauto/>

Android Auto, Google Play, Android, and other marks are trademarks of Google Inc.

APPLE CARPLAY™

REQUIREMENTS

- Apple Lightning® cable (Apple-certified cable)
- Latest iOS
- iPhone® 5 or above
- Data and wireless plan for applicable features

BEFORE YOU BEGIN

- Apple® CarPlay features may operate differently than on your phone.
- Message and data charges may apply when using Apple CarPlay.
- Apple CarPlay relies on the performance of your phone. If you experience performance issues:
 - Close all apps and then restart them
 - Disconnect and then reconnect your phone
- Using the Apple Lightning cable that was provided with your phone is recommended.

PHONE SETUP

On your phone, go to Settings > General > CarPlay to allow CarPlay access.

On your phone, go to Settings > Siri and ensure Siri is turned ON.

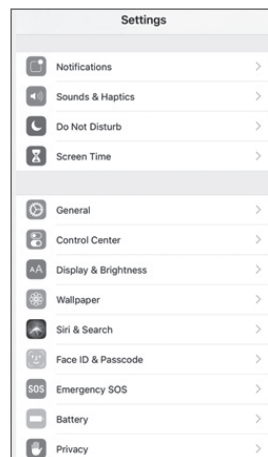

CAR SETUP

1. Press the SETUP button.
2. Touch the “Device Connections” icon on the screen.
3. Touch “iOS” on the Phone Projection Settings screen then touch “On” to enable Apple CarPlay.
4. Connect your Apple iPhone to the vehicle USB port then touch ‘OK’ when the pop-up message appears. The Apple CarPlay icon will now appear on the vehicle Home screen confirming the setup.

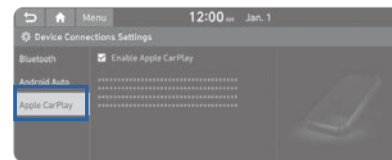

Apple CarPlay, Apple, and other marks are trademarks of Apple Inc.

CarPlay Home Screen

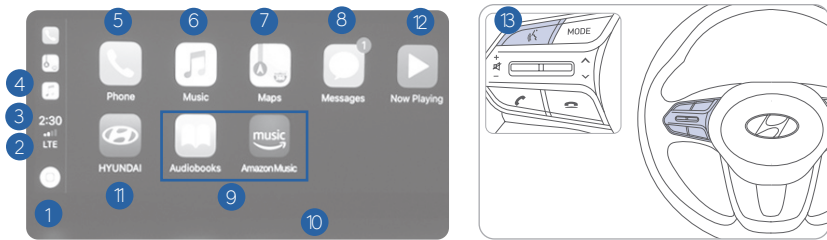

- | | |
|-------------------------|----------------------------------|
| 1 HOME ICON | 7 APPLE MAPS |
| 2 WIRELESS CONNECTIVITY | 8 MESSAGES |
| 3 CELLULAR SIGNAL | 9 3RD PARTY APPS |
| 4 PHONE TIME | 10 SCREEN PAGE INDICATOR |
| 5 PHONE | 11 EXIT TO HYUNDAI |
| 6 APPLE MUSIC™ | 12 CURRENT CARPLAY AUDIO PLAYING |
| | 13 VOICE RECOGNITION TIPS |

SIRI

Apple CarPlay uses Siri to perform many actions like sending messages, placing calls, and looking up/setting POI/Destinations. A Siri session can be initiated on any screen by:

1. Touch and holding the HOME icon 1 on the CarPlay screen or
2. Press the steering wheel VOICE RECOGNITION 13 button.

Note: Ensure Siri feature is set to ON in your phone (Go to Settings > General > Siri).

3. Say any of the following commands;
 - “Text <John Smith> ‘Call you later’” to send a text message.
 - “Read text messages” to read available text message.
 - “Call <John Smith>” to make a phone call.
 - “Find <POI/Destination>” to locate a POI/Destination.

PHONE

Touch the PHONE 5 icon to access the Phone screen. Siri will automatically asks ‘Who you would like to call’ when the PHONE 5 icon is selected.

NOTE: Phone call sound quality is dependent on the wired connection. Using the Lightning cable that came with the phone is recommended.

APPLE MUSIC

Touch the APPLE MUSIC 6 icon to access the Apple Music screen.

APPLE MAPS

Touch the APPLE MAPS 7 icon to access the Apple Map screen.

MESSAGES

Touch the MESSAGES 8 icon to access the Message screen. Siri will automatically asks ‘To hear unread messages or create a new one’ when the MESSAGE icon is selected.

3rd PARTY APPS

Supported CarPlay apps that are downloaded on your phone will appear on the CarPlay screen. Touch the apps icons to access those supported apps.

NOTE: A list of the supported CarPlay supported apps can be found at <http://www.apple.com/ios/carplay/>

Ensure phone has latest version of the 3rd Party Apps.

LANE KEEPING ASSIST (LKA)

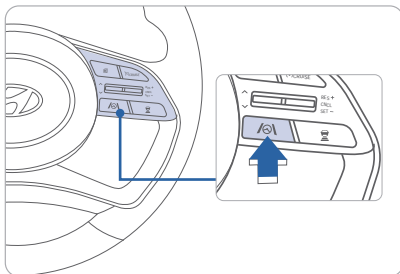

Lane Keeping Assist is designed to help detect lane markings (or road edges) while driving over a certain speed. LKA will warn the driver if the vehicle leaves the lane without using the turn signal, or will automatically assist the driver's steering to help prevent the vehicle from departing the lane.

With the engine on, press and hold the Lane Driving Assist button located on the steering wheel to turn on Lane Keeping Assist. The grey indicator light will illuminate on the cluster. Press and hold the button again to turn off the function.

LKA operates only when the vehicle speed is above 40 mph and when the Lane Safety indicator is green displayed in the instrument cluster. LKAS will not operate properly if the lane line is not clear, sharp bend in the road, or in heavy fog.

Refer to the Owner's Manual for more detailed information.

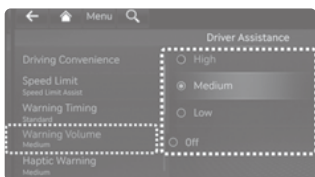

Warning Volume

With the engine on, select 'Driver Assistance → Warning Volume' from the Settings menu to change the Warning Volume to 'High', 'Medium', 'Low' or 'Off' for Lane Keeping Assist.

If you change the Warning Volume, the Warning Volume of other Driver Assistance systems may be changed as below.

Warning Volume	LKA	BCW	FCA	DAW	PDW	SEA	PCA
High	High Volume						
Medium	Medium Volume						
Low	Low Volume						
Off (If steering wheel haptic equipped)	No Sound (haptic ON)	Low Volume					

LKA: Lane Keeping Assist

BCW: Blind-Spot Collision Warning

FCA: Forward Collision-Avoidance Assist

DAW: Driver Attention Warning

PDW: Forward/Reverse Parking Distance Warning

SEA: Safe Exit Assist

PCA: Reverse Parking Collision-Avoidance Assist

LANE FOLLOWING ASSIST (LFA)

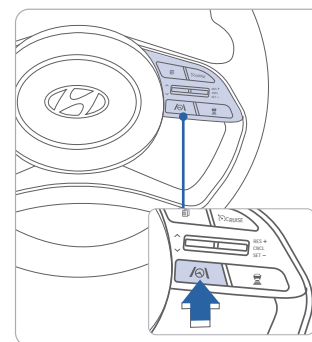

Lane Following Assist (LFA) helps detect lane markers on the road with a front view camera and assists the driver's steering to help keep the vehicle between lanes.

With the engine on, shortly press the Lane Driving Assist button located on the steering wheel to turn on Lane Following Assist. The grey or green indicator will illuminate on the cluster.

Press the button again to turn off the function.



FORWARD COLLISION-AVOIDANCE ASSIST (FCA)



Forward Collision-Avoidance Assist (FCA) is designed to help detect and monitor the vehicle ahead as well as detect a powered two-wheeler, pedestrian or cyclist in the roadway and warn the driver that a collision is imminent with a warning message and warning and apply emergency braking.

To operate the FCA, select the Active Assist sub menu in the LCD cluster display under User Settings.

Setup > Vehicle Settings > Driver Assistance > Forward Safety

Please refer to your Owner's Manual for further information.

Forward Cross-Traffic Safety (if equipped)

From the Settings menu to turn on Junction Crossing function and deselect to turn off the function.

Driver Assistance > Driving Safety > Forward Cross-Traffic Safety

The Junction Crossing functions help you to avoid collision by applying the emergency brake if an oncoming vehicle is detected.

Forward/Side Safety (if equipped)

From the Settings menu to turn on Lane-Change Oncoming function, Lane-Change Side function, Evasive Steering Assist function and deselect to turn off the function.

Driver Assistance > Driving Safety > Forward/Side Safety

The Lane-Change Oncoming, Lane-Change Side, Evasive Steering Assist functions help avoid a collision by assisting the driver's steering.

FCA activation example

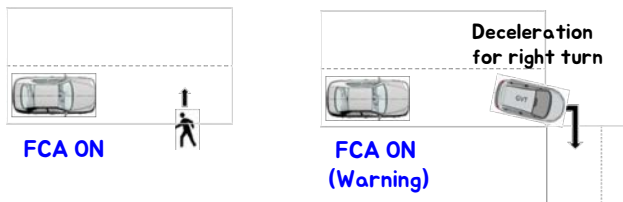

BLIND-SPOT COLLISION-WARNING (BCW) (if equipped)

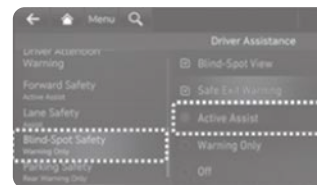

The Blind-Spot Collision Warning is designed to help detect and monitor approaching vehicles in the driver's blind spot area and warn the driver of a possible collision with a warning message and audible warning.

From the Settings menu you can set whether to use each function.
Driver Assistance > Driving Safety > Blind-Spot Safety

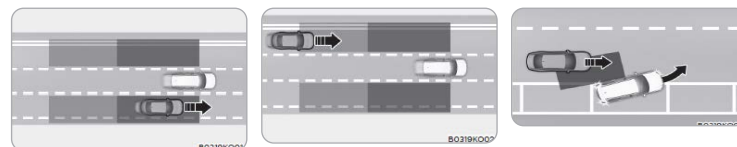

REAR CROSS-TRAFFIC COLLISION-AVOIDANCE ASSIST (RCCA)

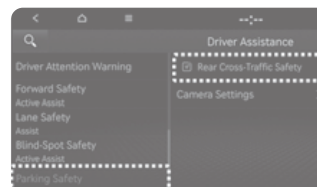

Rear Cross-Traffic Collision-Avoidance Assist is designed to help detect vehicles approaching from the left and right side while your vehicle is reversing, and warn the driver that a collision is imminent with a warning message and an audible warning. Also, braking is assisted to help prevent a collision.

Activate/Deactivate

In the Settings menu, select the following items in order:

1. Select User Settings
2. Select Driver Assistance
3. Select Parking Safety
4. Select Rear Cross Traffic Safety



SAFE EXIT ASSIST (SEA)

Safe Exit Assist helps prevent passengers from opening the door when a vehicle is approaching from the rear area. After the vehicle stops and an approaching vehicle from the rear area is detected, the rear door does not open from the inside handle. A “check surroundings then try again” warning message will appear on the cluster and a warning sound will go off.



When an approaching vehicle from the rear is detected and the door is already opened, a “watch for traffic” warning message appears and a warning sound will go off.

Activate/Deactivate

1. Select user settings
2. Select Driver Assistance
3. Driving Safety
4. Exit Safety

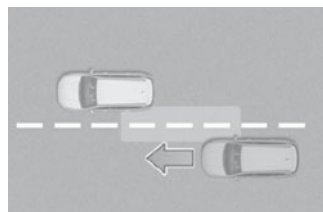

NOTE: If you press the child safety switch located on the driver door within 10 seconds after the warning message appears, the driver acknowledges the rear status and the child safety lock is canceled.

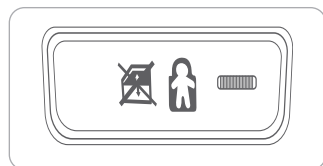

REAR OCCUPANT ALERT (ROA)

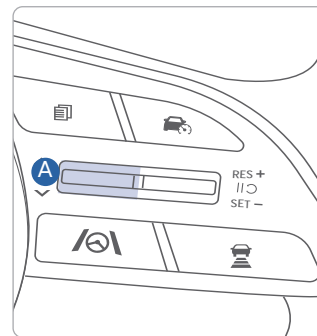

The Rear Occupant Alert system helps prevent exiting the vehicle with the rear passengers left in the vehicle.

1st Alert (standard)

When you open the front door after opening and closing the rear door and the engine is off, a “check rear seats” warning message appears.

2nd Alert (if equipped)

When any movement in the vehicle is detected after the driver’s door is closed and all doors are locked, the horn will activate for 25 seconds.

To stop this alert, unlock the door with the remote key or smart key.

Note: After the first alert, press the OK **A** button on the steering wheel to deactivate the second alert. If the system continues to detect movement, the horn activates up to 8 times. The system detects movement in the vehicle for 8 hours after the doors are locked.

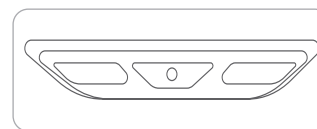

NOTE: The overhead sensor is located above the rear passenger seats.

Activate/Deactivate

Select the following items on the instrument cluster in order:

1. Select User Settings on the cluster LCD display
2. Select Convenience
3. Select Rear Seat Alert

IDLE STOP AND GO (ISG)

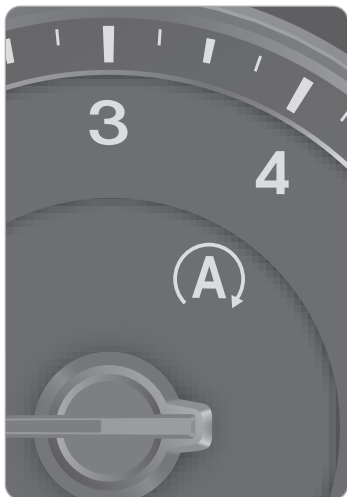

The ISG system will automatically shut off the engine when the vehicle is at a standstill (i.e. red stop light, stop sign, and traffic jam) to increase vehicle's fuel economy and reduce exhaust gas emissions. The auto stop indicator will illuminate in green on the instrument cluster when activated. To restart the engine in auto stop mode, release the brake pedal and press on the accelerator. The auto stop indicator goes OFF on the instrument cluster once the engine is restarted.

Prerequisite for activation:

- The driver's seatbelt is fastened.
- The driver's door and the hood are closed.
- The brake pressure is adequate.
- The battery is sufficiently charged.
- The outside temperature is between 14°F and 95°F (-10°C and 35°C).
- Engine is warmed up.
- The incline is gradual.
- Steering wheel is turned less than 180 degrees.
- Shift lever is in DRIVE or NEUTRAL.

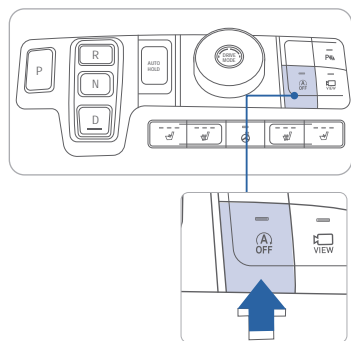

NOTE: The engine will not shut off if the prerequisites are not satisfied. In that case, the Auto Stop indicator will illuminate in yellow on the instrument cluster.

To deactivate

Press the ISG OFF button, indicator illuminates.

To activate

Press the ISG OFF button, indicator turns OFF.

DRIVE MODE (AWD)

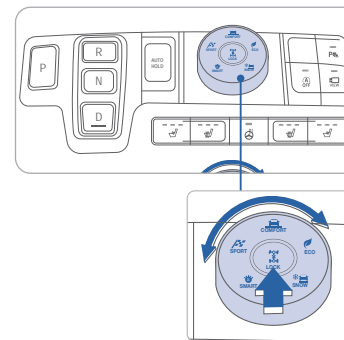

The mode changes, as below, whenever the DRIVE MODE selection knob is rotated. An indicator will illuminate on the instrument cluster when the vehicle is in sport mode or smart mode. When the vehicle is in comfort mode, it is not displayed on the instrument cluster.



COMFORT mode:

In comfort mode, the engine and transmission control logic work together to provide regular daily driving performance with fuel efficiency.

SPORT mode:

Sport mode manages the driving dynamics by automatically adjusting the steering effort, and the engine and transmission control logic for enhanced driving performance. When sport mode is activated, the engine RPM will be a little higher than normal.

SMART mode:

Smart mode selects the proper driving mode between comfort and sport by judging the driver's driving habits.

Note: Whenever the engine is restarted, the drive mode will revert back to the default comfort mode

ECO mode:

ECO mode helps to improve fuel efficiency. When the Eco mode is activated, the vehicle acceleration, gear shift points and air conditioning performance will be reduced to conserve the fuel economy.

SNOW mode:

In this mode, the vehicle can start safely by properly distributing the driving force of the vehicle on slippery roads such as snowy roads. And you can drive safely by suppressing wheel slip.

DRIVE MODE (FWD)

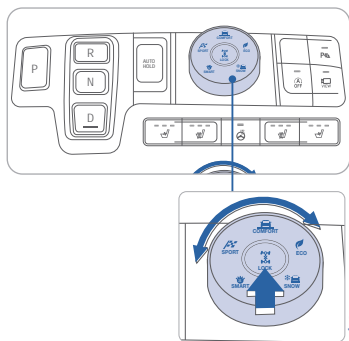

The mode changes, as below, whenever the DRIVE MODE selection knob is rotated. An indicator will illuminate on the instrument cluster when the vehicle is in sport mode or smart mode. When the vehicle is in comfort mode, it is not displayed on the instrument cluster.



COMFORT mode:

In comfort mode, the engine and transmission control logic work together to provide regular daily driving performance with fuel efficiency.

SPORT mode:

Sport mode manages the driving dynamics by automatically adjusting the steering effort, and the engine and transmission control logic for enhanced driving performance. When sport mode is activated, the engine RPM will be a little higher than normal.

SMART mode:

Smart mode selects the proper driving mode between comfort and sport by judging the driver's driving habits.

Note: Whenever the engine is restarted, the drive mode will revert back to the default comfort mode

ECO mode:

ECO mode helps to improve fuel efficiency. When the Eco mode is activated, the vehicle acceleration, gear shift points and air conditioning performance will be reduced to conserve the fuel economy.

TIRE PRESSURE MONITORING SYSTEM (TPMS)



Low Tire Pressure Indicator / TPMS Malfunction Indicator



Low Tire Pressure / Tire Pressure Monitor / TPMS Malfunction Display (shown on the cluster LCD display)

LOW TIRE PRESSURE INDICATOR



Illuminates if one or more of your tires are significantly under-inflated.

TPMS MALFUNCTION INDICATOR

Blinks for approximately one minute, then remains illuminated when there is a malfunction with the TPMS. Inspect all tires and adjust the tire pressure to specification. If the lamp remains illuminated, we recommend the vehicle be checked by an authorized HYUNDAI dealer.

LOW TIRE PRESSURE / TIRE PRESSURE MONITOR / TPMS MALFUNCTION DISPLAY(LCD DISPLAY)

Select the Driving Assist mode  by pressing the mode button on the steering wheel to display tire pressure.

Tire pressures will display after driving a short distance. If a tire pressure drops lower than predetermined specification, the Low Tire Pressure Indicator  will illuminate and the cluster  display will indicate tire(s) requiring air.

NOTE: Environmental factors can affect the tire pressure. The two main environmental factors are ambient air temperature and elevation. Colder ambient air will reduce tire pressure, while hotter ambient air will increase tire pressure. High elevation may also increase tire pressure.

SMART CRUISE CONTROL

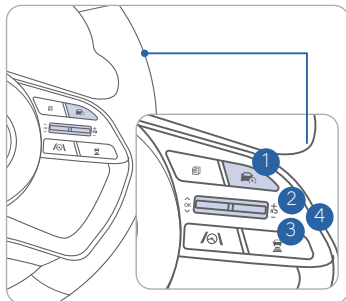

Smart Cruise Control is designed to help detect the vehicle ahead and help maintain the desired speed and minimum distance between the vehicle ahead.

- 1 To turn On/Off Smart Cruise Control.
- 2 Push "+" switch to Resume or Increase the set speed.
- 3 Push "-" switch DOWN to Set or Decrease the set speed.
- 4 Temporarily cancelling Smart Cruise Control.

Setting Vehicle Distance

SCC assist you in setting the distance from the vehicle ahead and will maintain the selected distance without you depressing the accelerator or the brake pedal.



Press the Vehicle distance button to set and maintain the vehicle-to-vehicle distance without pressing the accelerator or brake pedal. The vehicle-to-vehicle distance 1 will automatically activate when you set the set speed 2.

Each time the button is pressed, the vehicle-to-vehicle distance changes as follows:

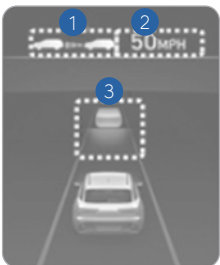

Turning on Smart Cruise Control

1. Press the Driving Assist button 1 to turn on Smart Cruise Control. The icon will illuminate in the instrument cluster.

Adjusting the vehicle speed

1. Push "+" switch 2 UP to increase set speed.
2. Push "-" switch switch 3 DOWN to decrease set speed.

NOTE: Quick toggle up/down will change speed by 1 mph. Holding switch up/down will change speed by 5 mph.

Temporarily cancelling Smart Cruise Control

Press the II switch button 4 or depress the brake pedal.

Please refer to your Owner's Manual for more information.

LEADING VEHICLE DEPARTURE ALERT

Leading Vehicle Departure Alert function alerts the driver of the departure of the vehicle in front when the vehicle is stopped.

To activate

In the Settings menu, select the following items in order:

1. Select User Settings on the cluster or AVNT LCD display.
2. Select Driver Assistance
3. Select Driver Attention Warning
4. Select Leading Vehicle Departure Alert

The function stops operation when the setting is deactivated. However, if the engine is turned off then on again, the function maintains in the previous state.

HIGHWAY DRIVING ASSIST (HDA) (if equipped)



Highway Driving Assist helps keep the vehicle between lanes, maintain a distance with the vehicle ahead, and automatically adjusts the vehicle speed to the speed limit while driving on the highway.

With the Engine Start/Stop button in the ON or START position, Highway Driving Assist can be activated from the Settings menu in the infotainment system screen by selecting the following:

'Setup → Vehicle Settings → Driver Assistance → Driving Convenience → Highway Driving Assist' Deselect the setting to turn off the system.

NOTE: If the engine is turned off then on again, the system maintains the last setting.

Highway Driving Assist operation

Highway Driving Assist operates when:

- Driving on the main road of highways, and turning on Highway Driving Assist by pressing the Driving Assist button.
- Entering the main road of highways while Lane Following assist and Smart Cruise Control are operating.
- Vehicle speed is under 120mph(200km/h).

PUSH BUTTON DRIVE SELECTOR

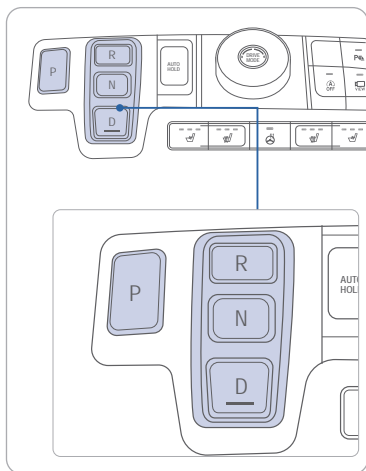

P (Park)
R (Reverse)
N (Neutral)
D (Drive)

P (Park)

Always come to a complete stop before shifting into P (Park). To shift from P (Park), you must depress firmly on the brake pedal and make sure your foot is off the accelerator pedal. The gear must be in P (Park) before turning the engine off.

Shift-lock system

For your safety, the automatic transmission has a shift-lock system which prevents shifting the gear from P (Park) or N (Neutral) to R (Reverse) or D (Drive) unless the brake pedal is depressed. To shift the gear from P (Park) or N (Neutral) to R (Reverse) or D (Drive):

1. Depress and hold the brake pedal.
2. Start the engine or place the ignition switch in the ON position.
3. Depress the brake pedal and push the R (Reverse) or D (Drive) button.

CAUTION: The surface of the drive selector can get very hot when exposed to direct sunlight, be cautious when shifting gears.

AUTO HOLD

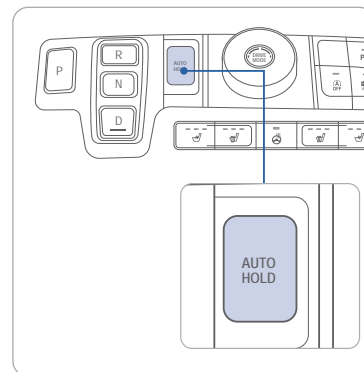

The Auto Hold feature assists in steep hill areas. It holds the brake until the accelerator pedal is pressed.

WHITE
AUTO
HOLD

1. Press the AUTO HOLD switch.

GREEN
AUTO
HOLD

2. Stop the vehicle by pressing the brake pedal. The brakes will remain engaged even if the brake pedal is released.

WHITE
AUTO
HOLD

3. The brakes will release when the accelerator pedal is pressed with transmission in D, R or manual mode.

To cancel the AUTO HOLD operation, press the AUTO HOLD switch again.

ELECTRIC PARKING BRAKE (EPB)

To apply and release EPB manually

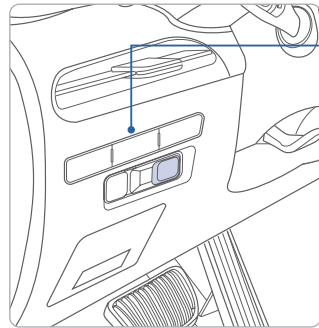

Applying



Stop the vehicle then pull the EPB switch.

Releasing



Press the EPB switch while depressing the brake pedal.

The EPB will automatically be applied when:

- Engine off while Auto Hold is enabled, parked on a slope, or with the engine off in park but the vehicle still moves a bit.

To release the automatic EPB:

- With engine running, depress the brake pedal and shift into R(Reverse) or D(Drive) .

NOTE: Please see the owner’s manual for additional details

TOW MODE (if equipped)

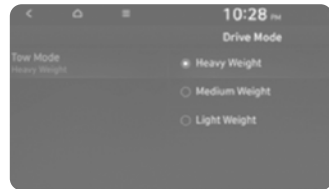
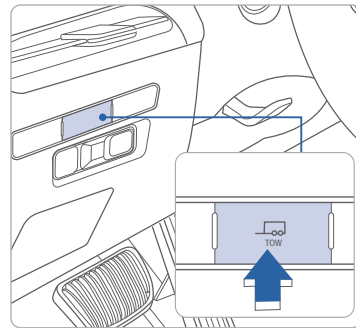

When towing a trailer, switching to TOW mode enables smooth driving by changing the shifting pattern to suit heavy loads.

Press the TOW mode button to turn function on or off.

With vehicle in P(Park), select ‘Setup>Vehicle>Drive Mode>Tow Mode’ on the infotainment system to set the weight of trailer to be towed.

PALISADE CUSTOMER DELIVERY CHECK LIST

HYUNDAI OWNER	DEALERSHIP NAME
SALES CONSULTANT	DATE
VIN	PREVIOUS VEHICLE

BEFORE DELIVERY

- ☐ CONFIRM “GOOD BATTERY” USING GR8 AND STAPLE TEST TICKET HERE
- ☐ SET TIRE PRESSURE LF__RF__RR__LR__
- ☐ VERIFY VEHICLE IS CLEAN, IN GOOD CONDITION, FREE OF CHIPS AND SCRATCHES · CLEAN WINDSHIELD AND BACK WINDOW
- ☐ ENSURE FLOORMATS ARE SNAPPED INTO PLACE

WALK THE CUSTOMER THROUGH EACH OF THE FOLLOWING KEY DELIVERY FEATURES

- ☐ REVIEW QUICK REFERENCE GUIDE
- ☐ BLUETOOTH
 - Show phone compatibility website: www.hyundaiusa.com/bluetooth
 - Pair customer's phone to the Bluetooth system (if equipped)
 - Make a test call using Bluetooth with the customer’s phone
 - Demonstrate Voice Recognition (VR)
- ☐ OPERATION OF THE NAVIGATION SYSTEM (if equipped) - page 37
- ☐ REVIEW AND TEAR OFF VOICE COMMAND / QUICK TIP CARD
- ☐ OPERATION OF THE AUDIO SYSTEM - page 36
- ☐ VEHICLE SETTINGS
 - Demonstrate vehicle settings in instrument cluster
 - Demonstrate navigation use, enter dealer address
 - Show radio presets

BLUETOOTH® HANDS-FREE HYUNDAI

CONNECTING YOUR PHONE

On the radio:

1. Push the **SETUP** button.
2. Select **Bluetooth**.
3. Select **Bluetooth Connection**.
4. Select **Add New**.

In your phone's Bluetooth settings:

5. Select the <Vehicle Name> on your phone.
6. Enter the passkey from the radio or accept the authorization pop-up on your phone.

SWITCHING BETWEEN PAIRED PHONES

Using Voice Command: “Change Bluetooth device”

On the radio:

1. Push the **SETUP** button.
2. Select **Bluetooth**.
3. Select **Bluetooth Connection**.
4. Select **Connect** next to the desired phone.

For more information, visit HyundaiBluetooth.com